

# Guidance notes for Submission of Online Application Form for Assessment on Portfolio Maintenance Requirements under the New Capital Investment Entrant Scheme

## 1) Introduction

### IHK-CIES03 Application for Assessment on Portfolio Maintenance Requirements under the New Capital Investment Entrant Scheme

1) Introduction

2) Important Announcement

3) Application Reference Number

4) Personal Particulars

5) Agent's Information

6) Holding Company Managed by Family Office

7) Financial Intermediary

8) Permissible Investment Assets

9) Portfolio Maintenance Requirements

10) Declaration of Applicant

11) Signature of Applicant

**Invest Hong Kong**  
The Government of the Hong Kong Special Administrative Region  
of the People's Republic of China

#### New Capital Investment Entrant Scheme

**Online Application for Assessment on Portfolio Maintenance Requirements**  
(Only applicable to applicants who need to apply to the Director of Immigration for extension of stay or unconditional stay)

For information on the Portfolio Maintenance Requirements of the New Capital Investment Entrant Scheme (New CIES), please visit [the New CIES website](#).

Upon expiry of your limit of stay, before you submit an application for extension of stay to the Director of Immigration (Dol), you are required to first approach the New CIES Office not earlier than three months before expiry of your limit of stay for verifying your continuous compliance with the Portfolio Maintenance Requirements. Please note that irrespective of whether you have secured the relevant Certifying Proof, you and your dependants, where any, are required to submit an application for extension of stay to Director of Immigration before expiry of your limit of stay.

Besides, if you wish to approach the New CIES Office, you are required to do so not earlier than three months before expiry of your limit of stay and not later than seven years.

Given the lead time required for processing the application, you are required to submit the application at least three months before the expiry of your limit of stay.

**An Applicant/Entrant must check this box to confirm that he/she is ready to submit an application for Assessment on Portfolio Maintenance Requirements.**

☐ I am ready to submit application for assessment on Portfolio Maintenance Requirements.

**How to Start**  
You can access the online service through the link at the bottom of this page. Please select a form language. If you change the form language while filling in the form, you will have to fill in the form again.

## 1) Introduction (Continued)

### Assistance and Further Information

If you need technical assistance in using the online service, you can contact the New CIES Office.

Address: 15/F, Revenue Tower, 5 Gloucester Road, Wan Chai, Hong Kong

Telephone no.: (852) 3904 3001

E-mail: [newcies@investhk.gov.hk](mailto:newcies@investhk.gov.hk)

Website: [www.newcies.gov.hk](http://www.newcies.gov.hk)

The opening hours are 9:00 a.m. to 12:30 p.m. and 1:30 p.m. to 5:00 p.m., Mondays to Fridays (closed on Saturdays, Sundays and public holidays).

The Frequently Asked Questions on application for the New CIES are available on the [New CIES webpage](#).

I Want To

- ☐ Start Filling in a New Form
- ☐ Fill in a Saved Form

The Applicant/Entrant may choose to fill in a New Form, or attach a Saved Form file from his/her device and enter his/her pre-set password to continue filling in a saved form.

## 2) Important Announcement

The Applicant/Entrant should read the Scheme Rules and the important notes carefully.

### Application for Assessment on Portfolio Maintenance Requirements under the New Capital Investment Entrant Scheme

Note:

- (i) Please read the "[Rules for the New Capital Investment Entrant Scheme](#)" ("[Scheme Rules](#)") carefully.
- (ii) Please complete this application in Chinese/English.
- (iii) Please ensure that all relevant parts are fully completed. Application will be considered on the basis of the information furnished on this application and on the documentary evidence provided.

Notwithstanding that you have already furnished the documents and information above, you may still be required to submit further supporting documents and information in connection with your application when necessary.

Warning: A person who knowingly and wilfully makes a statement or gives information which he/she knows to be false or does not believe to be true shall be guilty of an offence under the Laws of Hong Kong and the result of Assessment on Portfolio Maintenance Requirements shall have no effect.

\* Mandatory fields

Save

Back

Next

If the Applicant/Entrant wishes to complete his/her application later, he/she can click the "Save" button on any relevant page of the application form. When the "Save Form" window pops up, the Applicant/Entrant can set his/her own password and click "Save" again. The password-protected Saved Form file will be downloaded to his/her current device.

The Applicant/Entrant can later attach his/her Saved Form file and enter his/her pre-set password again in the first page of the online application form to continue filling in his/her saved form.

Save Form

This form data file (the file) will be saved into your current device. Please use a password to protect the file.

**Caution:** Please securely store this file and its password to enable future form completion by loading the file.

This system does not retain any form data associated with this file. Please be aware that if the file is lost or the password is forgotten, the entered data cannot be recovered.

- Password must be at least 8 characters
- Password must be including a number, an uppercase letter, a lowercase letter and a special character

Password \*

Confirm Password \*

Cancel

Save

### 3) Application Reference Number

#### Application Reference Number

 Please input your New CIES Application Reference Number issued by InvestHK.

Application Reference Number \*

XX

XXXXXX

XX

The Applicant/Entrant is required to fill in the Application Reference Number issued by InvestHK.

\* Mandatory fields

Save

Back

Next

#### 4) Personal Particulars

### Personal Particulars

Please fill in your personal information according to your travel document.

Surname in English \*

Given names in English \*

Date of birth



☐ I only have year and/or month of birth.

### Update of Personal Particulars

Do you have any updates on your personal particulars? \*

☐ Yes ☐ No

\* Mandatory fields

Save Back Next

The Applicant/Entrant should input his/her surname and given names according to his/her travel document.

The Applicant/Entrant must check to confirm if he/she has any updates on his/her personal particulars.

## 4) Personal Particulars (Continued)

**Update of Personal Particulars**

Do you have any updates on your personal particulars? \*

☒ Yes ☐ No

**About Update of Personal Particulars**

Please leave it blank if the item is without changes or not applicable.

Chinese Name

Maiden surname in English (if applicable)

Alias surname in English (if any)

Alias given names in English (if any)

Alias in Chinese (if any)

Sex

☐ Male ☐ Female

For unknown sex, please select both 'Male' and 'Female'.

Nationality / Place of domicile (applicable to Mainland, Macao and Taiwan residents)

Please Choose ...

Type of travel documents held

Please Choose ...

Hong Kong Identity Card Number (if any)

Date of issue (if any)

Residential address

Telephone no.

County Phone number

Personal email address

Correspondence address

If it is different from the residential address, you can provide your office address or provide other correspondence address.

Other telephone no.

County Phone number

\* Mandatory fields

Save Back Next

If the Applicant/Entrant selects "Yes", he/she can provide the updated personal particulars in the relevant box(es). If the item is without changes or not applicable, the box should be left blank.

## 5) Agent's Information

**Update of Agent's Information**

Do you have any updates on agent's information? \*

☐ Yes ☒ No

The Applicant/Entrant must check to confirm if he/she has any updates on his/her agent's information.

If you need to change your agent's information or appoint another agent to handle the application matters on your behalf in the future, you have to submit a written authorisation letter. The authorisation letter must clearly state the following information: the name of you and the agent, your identity document number, the contact information of the agent and the Affiliated Company (if applicable) including telephone number and email address, the effective date of the authorisation letter, the signature of you and the agent, etc.

\* Mandatory fields

Save Back Next

**Update of Agent's Information**

Do you have any updates on agent's information? \*

☒ Yes ☐ No

☐ I need to update my current agent's information.

☐ I have appointed and authorised another agent to handle the application on my behalf.

☐ I no longer appoint or authorise an agent to handle the application on my behalf.

If the Applicant/Entrant selects "Yes", he/she must choose an applicable option, and fill in the information as appropriate.

If you need to change your agent's information or appoint another agent to handle the application matters on your behalf in the future, you have to submit a written authorisation letter. The authorisation letter must clearly state the following information: the name of you and the agent, your identity document number, the contact information of the agent and the Affiliated Company (if applicable) including telephone number and email address, the effective date of the authorisation letter, the signature of you and the agent, etc.

\* Mandatory fields

Save Back Next

## 6) Holding Company Managed by Family Office

### Holding Company Managed by Family Office

Please refer to paragraphs 1.11 and 6.1 of the [Scheme Rules](#).

Are all/part of the Permissible investment assets held in the name of a Holding Company as specified in the Scheme Rules?

☒ Yes ☐ No

This Holding Company is required to fulfill the following conditions –

- (1) incorporated or registered in Hong Kong;
- (2) wholly owned by you;
- (3) only holds Permissible investment assets;
- (4) in the form of Family-owned Investment Holding Vehicle (FIHV), or Family-owned Special Purpose Entity under an FIHV, where the FIHV has at least two full-time employees in Hong Kong and incurs at least HK\$2 million operating expenditure annually in Hong Kong to carry out the activities of FIHV; and
- (5) managed by an Eligible Single Family Office of your family which manages assets specified under Schedule 16C to the Inland Revenue Ordinance for the FIHV(s) of the family with an aggregate Net asset value of not less than HK\$240 million.

Does your Holding Company fulfill all the above criteria? \*

☐ Yes ☐ No

Name of Holding Company \*

Business Registration No. of Company \*

Name of the Family Office \*

To the best of your knowledge, is there any other applicant(s) who has/have made investment under New CIES in the name of another Holding Company managed by the same Eligible Single Family Office, and has/have already submitted an application to InvestHK for assessment on Investment Requirements or assessment on Portfolio Maintenance Requirements? \*

☒ Yes ☐ No

Family Office Number for the New CIES of InvestHK (if any)



Please refer to the email from InvestHK on "Application from Holding Company Managed by Family Office" which was sent to other applicants from the same Eligible Single Family Office and fill in your Family Office Number.

Note:

If you need to enter more than one Holding Company, you can separate them with ;.

If the Applicant/Entrant holds the Permissible investment assets through a Holding Company which fulfills the conditions in paragraph 1.11 of the Scheme Rules, he/she is required to fill in the information of the Holding Company concerned and the Family Office of his/her family.

If applicable, the Applicant/Entrant should fill in the Family Office number as assigned by InvestHK in this box to the best of his/her knowledge.

Save

Back

Next



## 7) Financial Intermediary

**a) Designated Account in Own Name and Financial Intermediary**

Please refer to paragraph 6.1(a)(ii) of the [Scheme Rules](#).

☒ I hold part/all of the Permissible investment assets in a designated account in my own name.

☐ Authorised institution as defined in the Banking Ordinance (Cap. 155 of the Laws of Hong Kong)

☐ Corporation licensed to perform Type 1 or 9 regulated activities under the Securities and Futures Ordinance (Cap. 571 of the Laws of Hong Kong)

☐ Insurer permitted to carry on Class C business as specified in Part 2 of Schedule 1 under the Insurance Ordinance (Cap. 41 of the Laws of Hong Kong)

☐ I have not opened a designated account in my own name.

**b) Designated Account in Name of Holding Company and Financial Intermediary**

Please refer to paragraphs 1.11 and 6.1(a)(ii) of the [Scheme Rules](#).

☒ I hold part/all of the Permissible investment assets in a designated account in the name of a Holding Company in accordance with paragraph 1.11 of the Scheme Rules.

☐ Authorised institution as defined in the Banking Ordinance (Cap. 155 of the Laws of Hong Kong)

☐ Corporation licensed to perform Type 1 or 9 regulated activities under the Securities and Futures Ordinance (Cap. 571 of the Laws of Hong Kong)

☐ Insurer permitted to carry on Class C business as specified in Part 2 of Schedule 1 under the Insurance Ordinance (Cap. 41 of the Laws of Hong Kong)

Note:  
If you need to enter the Financial Intermediaries for more than one Holding Company, you can separate them with ;.

☐ I have not opened a designated account in the name of a Holding Company.

\* Mandatory fields

Save Back Next

If the Applicant/Entrant holds the Permissible investment assets in the designated account(s) in his/her own name, he/she is required to select the appropriate category(ies) of the appointed financial intermediary(ies) and fill in the information.

If there is no designated account opened in his/her own name, the Applicant/Entrant must check here.

If the Applicant/Entrant holds the Permissible investment assets in the designated account(s) in the name of a Holding Company, he/she is required to select the appropriate category(ies) and fill in the information of the appointed financial intermediary(ies).

If there is no designated account opened in the name of a Holding Company, the Applicant/Entrant must check here.

## 7) Financial Intermediary (Continued)

After selecting the appropriate category(ies), the Applicant/Entrant is required to fill in the information of the appointed financial intermediary(ies) in the boxes provided.

### a) Designated Account in Own Name and Financial Intermediary

Please refer to paragraph 6.1(a)(ii) of the [Scheme Rules](#).

☒ I hold part/all of the Permissible investment assets in a designated account in my own name.

☒ Authorised institution as defined in the Banking Ordinance (Cap. 155 of the Laws of Hong Kong)

Name of financial intermediary \*

ABC BANK

Account no. \*

ABCD1234

Name of contact person \*

CHAN TAI MAN

Post title \*

MANAGER

Telephone no. \*

+ 852 39043001 Ext. (if any)

Email address \*

newcies@investhk.gov.hk

☐ Corporation licensed to perform Type 1 or 9 regulated activities under the Securities and Futures Ordinance (Cap. 571 of the Laws of Hong Kong)

☐ Insurer permitted to carry on Class C business as specified in Part 2 of Schedule 1 under the Insurance Ordinance (Cap. 41 of the Laws of Hong Kong)

☐ I have not opened a designated account in my own name.

### b) Designated Account in Name of Holding Company and Financial Intermediary

Please refer to paragraphs 1.11 and 6.1(a)(ii) of the [Scheme Rules](#).

☒ I hold part/all of the Permissible investment assets in a designated account in the name of a Holding Company as defined in paragraph 1.11 of the Scheme Rules.

☒ Authorised institution as defined in the Banking Ordinance (Cap. 155 of the Laws of Hong Kong)

Name of financial intermediary \*

ABC BANK

Account no. \*

ABCD1234

Name of contact person \*

CHAN TAI MAN

Post title \*

MANAGER

Telephone no. \*

+ 852 39043001 Ext. (if any)

Email address \*

newcies@investhk.gov.hk

☐ Corporation licensed to perform Type 1 or 9 regulated activities under the Securities and Futures Ordinance (Cap. 571 of the Laws of Hong Kong)

☐ Insurer permitted to carry on Class C business as specified in Part 2 of Schedule 1 under the Insurance Ordinance (Cap. 41 of the Laws of Hong Kong)

Note:

If you need to enter the Financial Intermediaries for more than one Holding Company, you can separate them with ;.

☐ I have not opened a designated account in the name of a Holding Company.

## 8) Permissible Investment Assets

### Permissible Investment Assets

Please fill in the Hong Kong Dollar (HK\$) equivalent of the values of Permissible investment asset(s) and the amount invested in real estate as at the end date of the latest anniversary period after the grant of Formal Approval by the Immigration Department in accordance with your submitted Portfolio Maintenance Requirement Anniversary Statement enclosed in your Fulfillment document for the latest anniversary.

The end date of the latest anniversary period after the grant of Formal Approval \*

YYYY-MM-DD 

The Applicant/Entrant must fill in the end date of the latest anniversary period after the grant of Formal Approval.

### (1) Investment in Permissible Financial Assets

Please refer to paragraph 5.1(a)-(f) of the [Scheme Rules](#).

HK\$ equivalent of asset value

#### (a) Equities

HK\$ equivalent

The Applicant/Entrant must fill in the Hong Kong dollar equivalent value of the Permissible financial assets as at the end date of the latest anniversary period.

#### (b) Debt securities

HK\$ equivalent

#### (c) Certificates of deposits

HK\$ equivalent

#### (d) Subordinated debt

HK\$ equivalent

#### (e) Eligible Collective Investment Schemes

☐ Please click if applicable

(f) Ownership interest in limited partnership funds ("LPFs") registered under the Limited Partnership Fund Ordinance (Cap. 637 of the Laws of Hong Kong)

☐ Please click if applicable

### SUB-TOTAL OF PERMISSIBLE FINANCIAL ASSETS:

0

## 8) Permissible Investment Assets (Continued)

### (2) Investment in Real Estate

Please refer to paragraph 5.2 of the [Scheme Rules](#).

The real estate should be held in your own name or through a sole proprietorship under your name, or through a company of which you being the sole shareholder (including Holding Company as defined in paragraph 1.11 of the Scheme Rules). Non-residential real estate and residential real estate mean "non-residential property" and "residential property" as defined in section 29A of the Stamp Duty Ordinance (Cap. 117 of the Laws of Hong Kong) respectively.

**HK\$ equivalent of amount invested**

(Acquisition value net of outstanding mortgage as at the end date of the latest anniversary period (if applicable))

**Non-residential Real Estate**

HK\$ equivalent

**Residential Real Estate**

HK\$ equivalent

**SUB-TOTAL OF REAL ESTATE:**

0

Regarding the real estate, the Applicant/Entrant must fill in the Hong Kong dollar equivalent value of the investment (acquisition value net of outstanding mortgage as at the end date of the latest anniversary period (if applicable)).

## 8) Permissible Investment Assets (Continued)

**(3) CIES Investment Portfolio**

Please refer to paragraphs 5.3 and 5.4 of the [Scheme Rules](#).

☒ I have placed HK\$3 million into the CIES Investment Portfolio (CIES IP).  
☐ The HK\$3 million deposited cash in the designated account for subsequent placing into the CIES IP remains and is not dissipated.

Date of placement into the CIES Investment Portfolio \*

YYYY-MM-DD 

---

**Total of Permissible investment assets ( (1) + (2) + (3) )**

3000000

---

\* Mandatory fields

Save Back Next

The Applicant/Entrant is required to select and fill in the information for the Capital Investment Entrant Scheme Investment Portfolio.

---

**(3) CIES Investment Portfolio**

Please refer to paragraphs 5.3 and 5.4 of the [Scheme Rules](#).

☐ I have placed HK\$3 million into the CIES Investment Portfolio (CIES IP).  
☒ The HK\$3 million deposited cash in the designated account for subsequent placing into the CIES IP remains and is not dissipated.

Name of financial intermediary \*

Account no. \*

---

**Total of Permissible investment assets ( (1) + (2) + (3) )**

3000000

---

\* Mandatory fields

Save Back Next

## 9) Portfolio Maintenance Requirements

### Portfolio Maintenance Requirements

As stipulated in paragraph 4.10, 4.11 and/or 6.2 of the [Scheme Rules](#), you are required to declare whether you have continuously complied with the Portfolio Maintenance Requirements under the New CIES.



As it takes time for the New CIES Office to process, you and your dependants, where any, are required to submit an application for extension of stay to Director of Immigration before expiry of your limit of stay, notwithstanding the relevant Certifying Proof may have not yet been secured from New CIES Office.

Expiry date of existing e-Visa issued by Immigration Department \*

YYYY-MM-DD



File upload for existing e-Visa issued by Immigration Department \*



Choose a file or drag it here  
Accept file format: PDF, JPG, JPEG  
Size up to 3.0 MB

The Applicant/Entrant must fill in the expiry date of existing e-Visa and upload the photocopy of it.

## 9) Portfolio Maintenance Requirements (Continued)

**Declaration**

Have you remained to be the absolute beneficial owner of all the Permissible investment assets since the date of your previous declaration to the New CIES Office? \*

☒ Yes  
☐ No, and as reported below.

Have you continuously complied with the Portfolio Maintenance Requirements since the date of your previous declaration to the New CIES Office? \*

☒ Yes  
☐ No, and as reported below.

The Applicant/Entrant must check the box to declare whether he/she has remained to be the absolute beneficial owner of all the Permissible investment assets and continuously complied with the Portfolio Maintenance Requirements of the Scheme Rules.

**Declaration**

Have you remained to be the absolute beneficial owner of all the Permissible investment assets since the date of your previous declaration to the New CIES Office? \*

☐ Yes  
☒ No, and as reported below.

Have you continuously complied with the Portfolio Maintenance Requirements since the date of your previous declaration to the New CIES Office? \*

☐ Yes  
☒ No, and as reported below.

I report the following incidents since my previous declaration to the New CIES Office, and attach the supporting documents (multiple options can be selected). \*

☐ I have not remained to be the absolute beneficial owner of all the Permissible investment assets.  
☐ I have not switched my Permissible investment assets within the stipulated timeframes.  
☐ I have not re-invested the gross amount entirely upon my withdrawal/disposal of my Permissible investment assets.  
☐ I have not topped up my investment for expenses incurred during the process of acquiring, disposing or realising the Permissible investment assets.  
☐ Some assets in my designated account have been charged, assigned or created to interest in favor of a third party.  
☐ I have not maintained the HK\$3 million for subsequent placing into the Capital Investment Entrant Scheme Investment Portfolio in the designated account or timely placing it into the Portfolio.  
☐ I have to report other non-compliance incident(s).

File upload for non-compliant incident \*

 Choose a file or drag it here  
Accept file format: PDF  
Size up to 3.0 MB

File upload for explanation/follow-up measures \*

 Choose a file or drag it here  
Accept file format: PDF  
Size up to 3.0 MB

\* Mandatory fields

Save Back Next

If "No", the Applicant/Entrant must check the appropriate item for the non-compliant incident, and upload the relevant documents of the incident and explanation/follow-up measures.

## 10) Declaration of Applicant

### Declaration of Applicant

- (i) I declare that the information given in the application and all the supporting documents is correct, complete and true to the best of my knowledge and belief.
- (ii) I declare that the aforesaid Permissible investment assets are under my absolute beneficial entitlement and the purchase price(s) and additional investment (if any) is/are paid out of my and/or my Holding Company's bank account and own monies.
- (iii) I consent to the making of any enquiries necessary for the processing of this application.
- (iv) I consent to releasing my information to my appointed bodies, as well as any government bureaux, departments and any other public or private organisations inside or outside the Hong Kong Special Administrative Region ("HKSAR") for the purpose of processing of this application.
- (v) I authorise all government departments or authorities, other quasi-government organisations and the Hong Kong Investment Corporation Limited and its appointed organisations to release any record or information which Invest Hong Kong of the Government of the HKSAR may require for the processing of this application.
- (vi) I understand that the Director-General of Investment Promotion has absolute discretion to approve or disapprove this application.
- (vii) I understand that any investment in Hong Kong is and remains my sole decision and responsibility. The Government of the HKSAR and the Director-General of Investment Promotion shall not be liable for any loss on my investment pursuant to the New Capital Investment Entrant Scheme howsoever arising.
- (viii) I have read and understood the Rules for the New Capital Investment Entrant Scheme and I hereby undertake to abide by them if permitted to remain in Hong Kong as an Entrant under the New Capital Investment Entrant Scheme. I understand that failure to comply with the Rules for the New Capital Investment Entrant Scheme will render my application not being considered and my entitlement under the New Capital Investment Entrant Scheme being discontinued.

☒ I have read the provisions of this Declaration carefully and fully understood my obligations and liabilities under this Declaration. \*

The Applicant/Entrant must check the box to confirm that he/she has read the provisions of the Declaration carefully and fully understood his/her obligations and liabilities under the Declaration.

Save

Back

Next



## 11) Signature of Applicant

### Signature of Applicant

Please upload an image of your signature. \*



Choose a file or drag it here  
Accept file format: JPG, JPEG, PNG  
Size up to 2.0 MB

The Applicant/Entrant must upload an image of his/her signature in the specified format within the size limit.

\* Mandatory fields

Save

Back

Next

## 12) Statement of Purpose

**Statement of Purpose**

**1. Purpose of Collection**  
The personal data provided in the application will be used by Invest Hong Kong for one or more of the following purposes:

1. to process your application;
2. for statistics and research purposes on the condition that the resulting statistics or results of the research will not be made available in a form which will identify the data subjects or any of them; and
3. any other legitimate purposes as may be required, authorised or permitted by law.

The provision of personal data by means of this application is voluntary. If you do not provide sufficient information, we may not be able to process your application or to conduct the record search or positively identify the record.

**2. Classes of Transferees**  
The personal data you provide may be disclosed to any government bureaux, departments and any other public or private organisations inside or outside the Hong Kong Special Administrative Region for the purposes mentioned above.

**3. Access to Personal Data**  
You have a right to request access to and correction of your personal data as provided for in sections 18 and 22 and Principle 6 of Schedule 1 of the Personal Data (Privacy) Ordinance (Chapter 488). Your right of access includes the right to obtain a copy of your personal data provided in the application subject to payment of a fee.

Enquiries concerning the personal data collected by means of the application, including making of access and corrections, should be addressed to:

Head of Corporate Services, Invest Hong Kong

Address: 25/F, Fairmont House, 8 Cotton Tree Drive, Central, Hong Kong  
Telephone no.: (852) 3107 1073  
E-mail address: data-protection@investhk.gov.hk

**4. General Enquiries**  
For general enquiries, please contact us at:

Telephone no.: (852) 3904 3001  
E-mail address: newcies@investhk.gov.hk  
Website: www.newcies.gov.hk

\* Mandatory fields

Save Back Next

The Applicant/Entrant shall read the Statement of Purpose for Collection of Personal Data carefully.

### 13) Review & Confirm

#### 3. Access to Personal Data

You have a right to request access to and correction of your personal data as provided for in sections 18 and 22 and Principle 6 of Schedule 1 of the Personal Data (Privacy) Ordinance (Chapter 486). Your right of access includes the right to obtain a copy of your personal data provided in the application subject to payment of a fee.

Enquiries concerning the personal data collected by means of the application, including making of access and corrections, should be addressed to:

Head of Corporate Services, Invest Hong Kong

Address: 25/F, Fairmont House, 8 Cotton Tree Drive, Central, Hong Kong

Telephone no.: (852) 3107 1073

E-mail address: data-protection@investhk.gov.hk

#### 4. General Enquiries

For general enquiries, please contact us at:

Telephone no.: (852) 3904 3001

E-mail address: newcies@investhk.gov.hk

Website: www.newcies.gov.hk

The Applicant/Entrant should review his/her application summary carefully and provide an email address to receive the acknowledgement email for future reference before clicking "Submit".

#### **Submission Acknowledgement**

Please provide your email address to receive acknowledgement email for future reference:

Email \*

If the Applicant/Entrant wishes to amend the information, he/she can click "Back" to return to the respective page.

\* Mandatory fields

Save

Back

Submit

### 13) Review & Confirm (Continued)

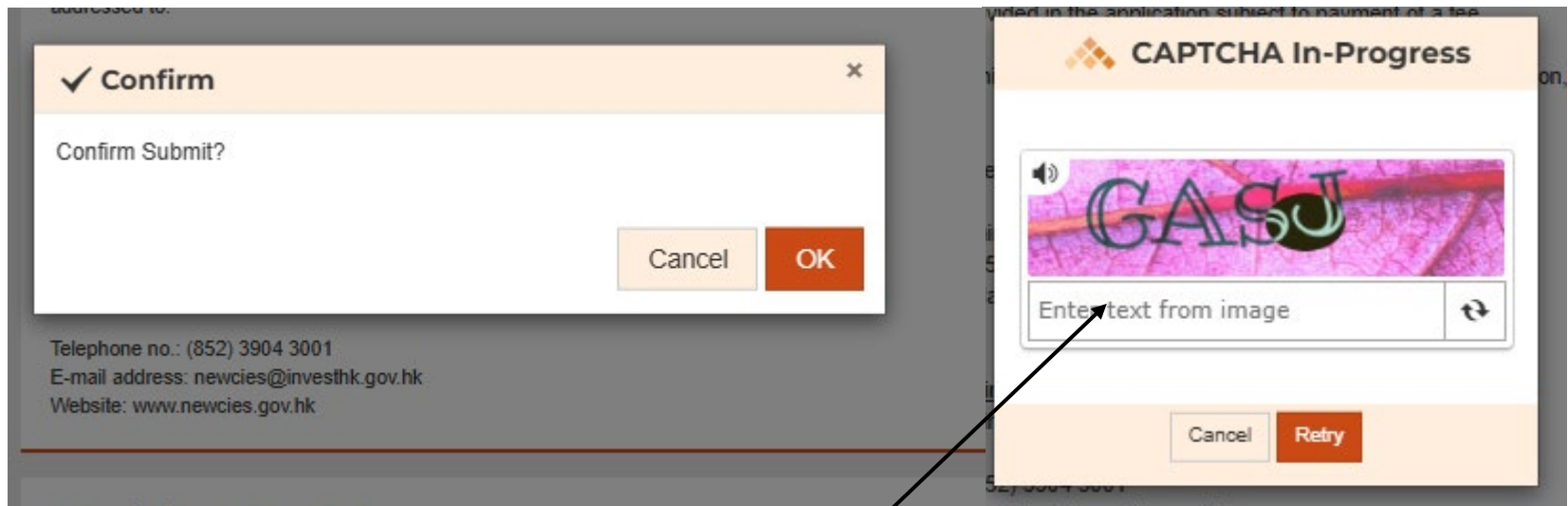

Once "OK" is selected, the CAPTCHA test will appear on the screen for completion before submission.

If any information in the online application form has to be revised after submission, the Applicant/Entrant should contact the New CIES Office by email (newcies@investhk.gov.hk) instead of submitting another online application form. Duplicate submissions of online application forms may result in confusion and a significant delay in the assessment process.

## **14) Acknowledgement**

### **Submission Details**

Thank you for using our e-Form service. Your submission has been received and will be forwarded to the concerned bureau, department or organisation for processing. Please quote the transaction reference number below for future communication related to this submission, including any enquiries or subsequent submission of supporting documents.

**Print / Download Submitted Form Record**

The Applicant/Entrant should print and download his/her submitted form after he/she completes the online application for future reference.

Submission Date and Time (YYYY-MM-DD HH:MM)

Transaction Reference Number

IHK0030B71T8VIHH

Should you have any enquiries, please contact the respective bureau, department or organisation -

New CIES Office

Hotline: 3904 3001

Email: newcies@investhk.gov.hk